

Take Control. ion Genesis

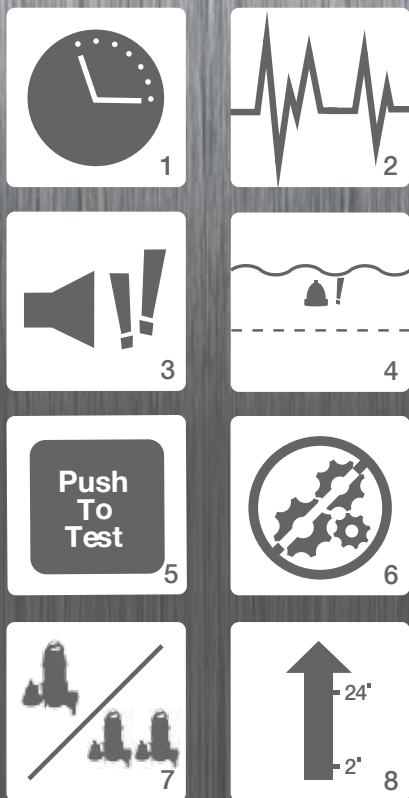

1. Installs in minutes with no hard wiring or complex programming involved.
2. Non-stop monitoring and trending of vital pump and system information to ensure equipment is properly working at all times.
3. Any variation in system performance will trigger an alarm to notify the user of potential equipment failure before flooding occurs.
4. Ion® High Water Sensor also acts as an override switch that keeps the pump operational in case the primary sensor malfunctions.
5. Ion Genesis® controller allows for users to test the pump/pumps at the touch of a button, without ever having to access the basin.
6. Ion® Digital Level Sensors are non-mechanical with no moving parts to wear out; making them far more reliable than standard float switches.
7. Will operate a single pump or alternate two pumps.
8. Manually adjusts the pump turn on level from 2" to 24" in 0.5" increments.

SMART CONTROLLER, SMART SENSORS



Patent Pending

www.ionstormpro.com

SMART SENSING TECHNOLOGY



The Ion Genesis® is a first of a kind digital pump controller that is designed to operate one or two pumps. The Ion® Digital Level Sensors are used in place of standard float switches. These digital sensors incorporate smart sensing technology that accurately detects water level.

You can collect and analyze system data never before possible with the float switch controllers. Any change/variation in your system performance will sound an alarm or alert of possible equipment failure before flooding occurs. This new technology allows you to adjust the turn on level of your system without removing the system cover. Ion Genesis®: Tomorrow's technology, today.

ION GENESIS® FEATURES

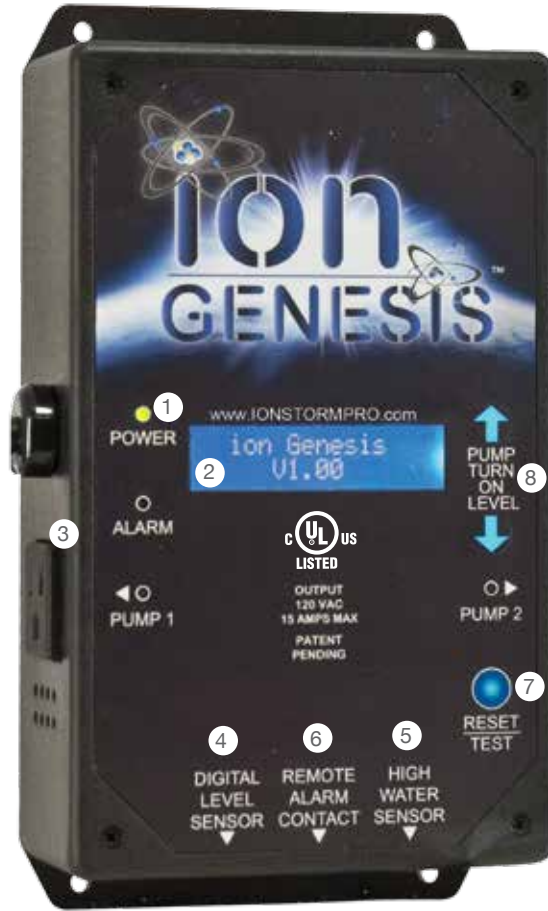

- LED Lights:** Indicate when the pump or pumps are running, system power, and alarm mode.
- LCD Screen:** Displays vital equipment information such as pump amp draw, water level, and alarm notifications.
- Plug & Play Outlets:** Pump(s) plug directly into controller just as they would a wall outlet.
- Ion® Digital Level Sensor:** Operates a single pump or alternates two pumps. Solid state design ensures high reliability.
- Ion® Digital High Water Sensor:** Detects high water and also acts as a secondary sensor in case the primary Ion® sensor fails.
- Remote Alarm Contact:** Connects to optional dialer or existing security system for remote monitoring when you're away.
- Reset/Test Button:** Allows user to manually test system without having to access basin.
- On Level:** Manually adjust the pumping turn on level from 2" to 24" in 0.5" increments.

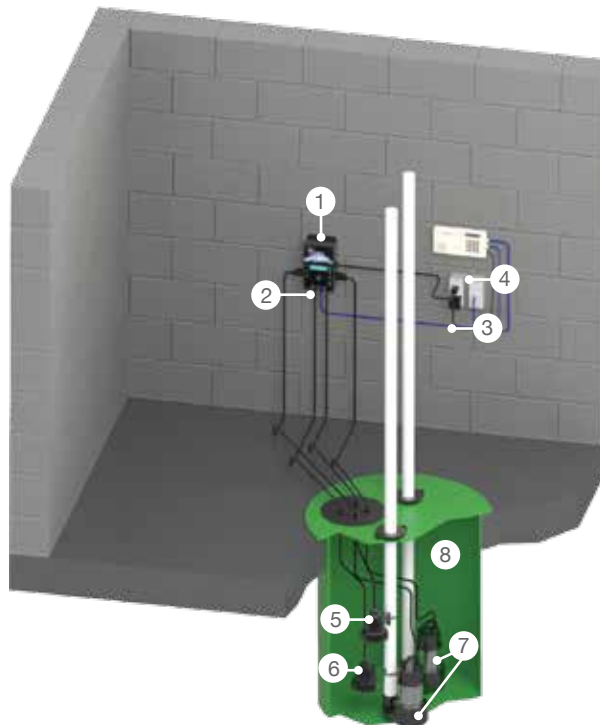

TYPICAL INSTALLATION OF ION GENESIS®

- Ion Genesis®
- Sensor connectors
- Power cord
- Wall outlet
- High water sensor
- Digital level sensor
- Pumps
- Basin

Shown with optional dialer



37 Forestwood Dr., Romeoville, IL 60446
(800) 323-1665 www.ionstormpro.com